

# 20 系列

## 铝型材 20 系列

铝型材 20 系列, 槽宽 6mm, 主要应用于轻负载结构。

20x20-2 槽 N 型

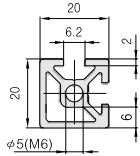
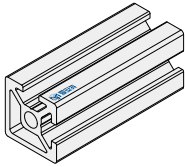

20x20-3 槽

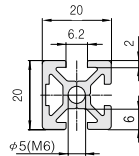
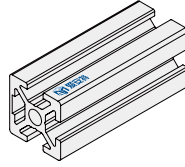

20x20-4 槽

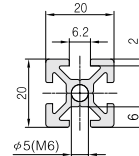
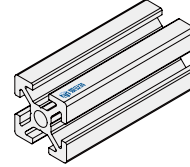

20x40-2 槽

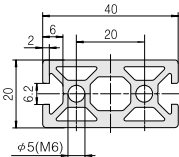
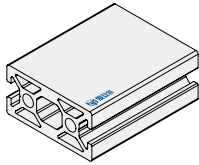

20x40-6 槽

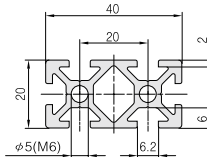
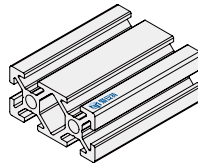

20x60-8 槽

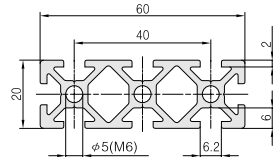
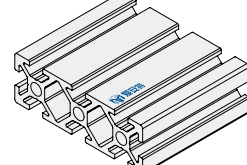

40x40-8 槽

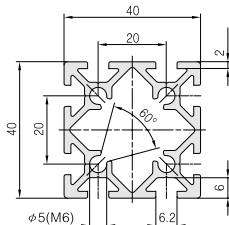
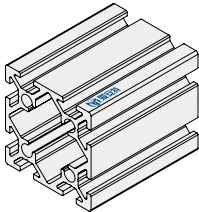

⚠️ “□”代表长度及补充加工, 详见 P 11 - P 16。  
若整根订制, 直接使用订购编号即可。

产品描述	截面积 (mm <sup>2</sup> )	惯性矩 Ix (cm <sup>4</sup> )	惯性矩 Iy (cm <sup>4</sup> )	弯矩 Wx (cm <sup>3</sup> )	弯矩 Wy (cm <sup>3</sup> )	重量 (kg/m)	订购编号
20 系列 20x20 2 槽 N 型	193.15	0.81	0.81	0.79	0.79	0.52	AA20-2020-2-N-□
20 系列 20x20 3 槽	186.69	0.75	0.81	0.75	0.79	0.50	AA20-2020-3-□
20 系列 20x20 4 槽	180.23	0.75	0.75	0.75	0.75	0.49	AA20-2020-4-□
20 系列 20x40 2 槽	402.11	1.90	5.63	1.90	2.82	1.09	AA20-2040-2-□
20 系列 20x40 6 槽	324.02	1.38	5.10	1.38	2.55	0.88	AA20-2040-6-□
20 系列 20x60 8 槽	467.80	2.02	15.90	2.02	5.30	1.26	AA20-2060-8-□
20 系列 40x40 8 槽	477.31	8.96	8.96	4.48	4.48	1.29	AA20-4040-8-□

### 推荐连接件 ·····



压铸角铝  
P34



挤压角铝  
P44



槽内直线件  
P58



大螺栓  
P59



L 形角槽连接件  
P60