

# 40 系列

## 铝型材 40 系列

铝型材 40 系列, 槽宽 10mm, 适用于中度负载或重负载结构: 机器结构框架、物料车、工作台、工厂车间隔断、展示架等。是应用最为广泛的型材系列。

### 40x40-2 槽 R 型

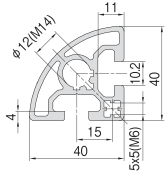
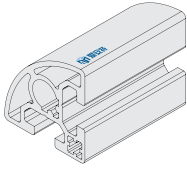

### 40x40-2 槽 N 型

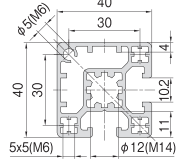
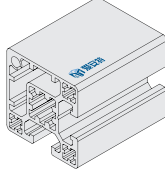

### 40x40-3 槽

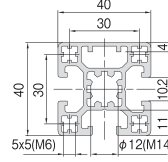
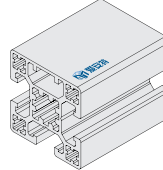

### 40x40-4 槽 超轻型

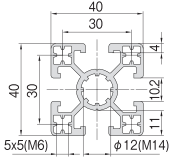
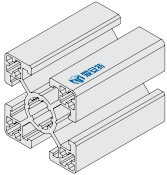

### 40x40-4 槽 轻型

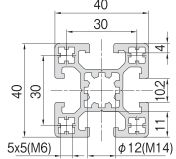
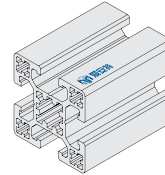

### 40x40-4 槽

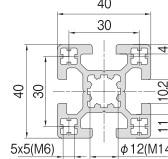
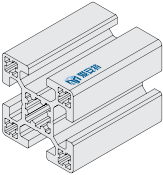

### 40x40-4 槽 重型

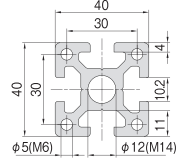
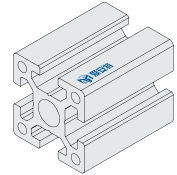

### 40x80-6 槽 超轻型

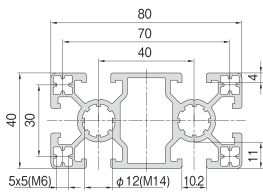
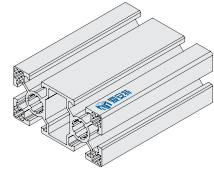

### 40x80-6 槽 轻型

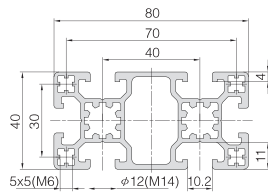
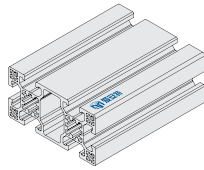

### 40x80-6 槽

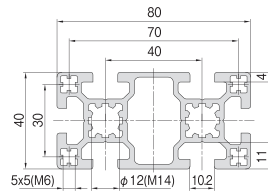
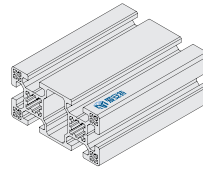

### 40x80-6 槽 重型

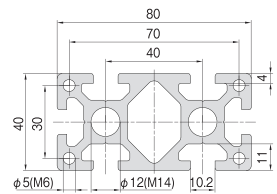
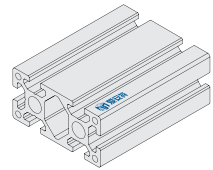

### 40x120-8 槽

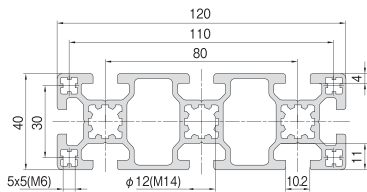
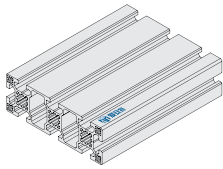

### 40x120-8 槽 重型

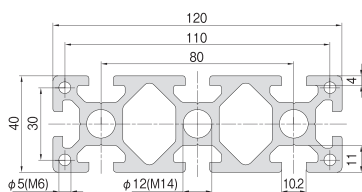
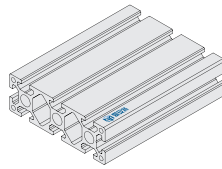

# 40 系列

40x160-10 槽

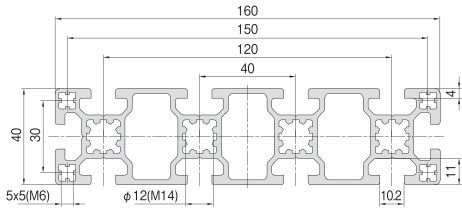
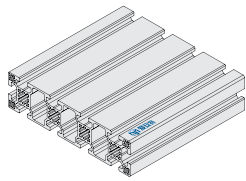

40x160-10 槽 重型

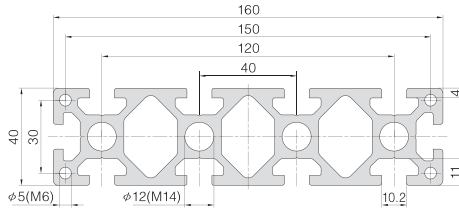
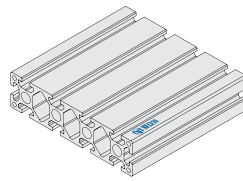

80x80-8 槽

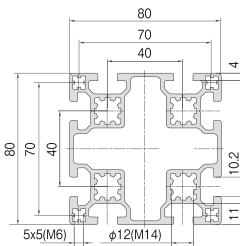
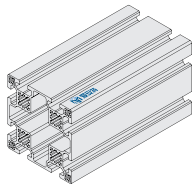

80x80-8 槽 重型

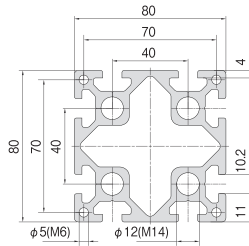
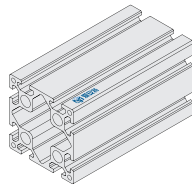

80x160-12 槽

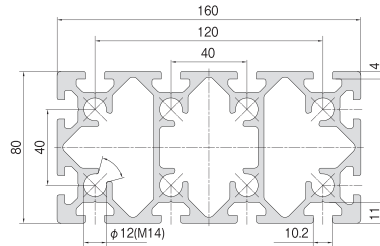
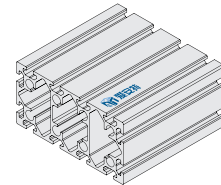

120x120-12 槽

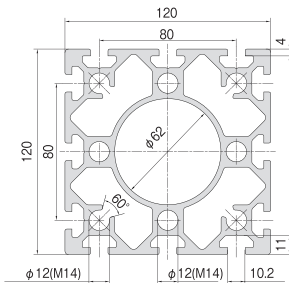
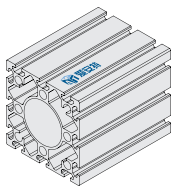

| 产品描述                 | 截面积 (mm <sup>2</sup> ) | 惯性矩 I <sub>x</sub> (cm <sup>4</sup> ) | 惯性矩 I <sub>y</sub> (cm <sup>4</sup> ) | 弯矩 W <sub>x</sub> (cm <sup>3</sup> ) | 弯矩 W <sub>y</sub> (cm <sup>3</sup> ) | 重量 (kg/m) | 订购编号              |
|----------------------|------------------------|---------------------------------------|---------------------------------------|--------------------------------------|--------------------------------------|-----------|-------------------|
| 40 系列 40x40 2 槽 R 型  | 477.42                 | 6.88                                  | 6.88                                  | 3.03                                 | 3.03                                 | 1.29      | AA40-4040-2-R-□   |
| 40 系列 40x40 2 槽 N 型  | 526.42                 | 8.91                                  | 8.91                                  | 4.46                                 | 4.46                                 | 1.42      | AA40-4040-2-N-□   |
| 40 系列 40x40 3 槽      | 536.35                 | 9.05                                  | 8.69                                  | 4.46                                 | 4.35                                 | 1.45      | AA40-4040-3-□     |
| 40 系列 40x40 4 槽 超轻型  | 468.51                 | 7.44                                  | 7.44                                  | 3.72                                 | 3.72                                 | 1.27      | AA40-4040-4-SL-□  |
| 40 系列 40x40 4 槽 轻型   | 528.89                 | 8.73                                  | 8.73                                  | 4.37                                 | 4.37                                 | 1.43      | AA40-4040-4-L-□   |
| 40 系列 40x40 4 槽      | 569.89                 | 9.20                                  | 9.20                                  | 4.60                                 | 4.60                                 | 1.54      | AA40-4040-4-□     |
| 40 系列 40x40 4 槽 重型   | 728.64                 | 11.60                                 | 11.60                                 | 5.80                                 | 5.80                                 | 1.97      | AA40-4040-4-H-□   |
| 40 系列 40x80 6 槽 超轻型  | 858.24                 | 14.55                                 | 52.74                                 | 7.28                                 | 13.19                                | 2.32      | AA40-4080-6-SL-□  |
| 40 系列 40x80 6 槽 轻型   | 903.48                 | 15.98                                 | 59.66                                 | 7.99                                 | 14.92                                | 2.44      | AA40-4080-6-L-□   |
| 40 系列 40x80 6 槽      | 973.88                 | 16.83                                 | 63.86                                 | 8.42                                 | 15.97                                | 2.63      | AA40-4080-6-□     |
| 40 系列 40x80 6 槽 重型   | 1321.39                | 22.45                                 | 81.46                                 | 11.23                                | 20.37                                | 3.57      | AA40-4080-6-H-□   |
| 40 系列 40x120 8 槽     | 1377.88                | 24.45                                 | 196.47                                | 12.23                                | 32.75                                | 3.72      | AA40-40120-8-□    |
| 40 系列 40x120 8 槽 重型  | 1914.14                | 33.31                                 | 257.20                                | 16.66                                | 42.87                                | 5.17      | AA40-40120-8-H-□  |
| 40 系列 40x160 10 槽    | 1781.87                | 32.07                                 | 439.35                                | 16.04                                | 54.92                                | 4.81      | AA40-40160-10-□   |
| 40 系列 40x160 10 槽 重型 | 2506.88                | 44.15                                 | 585.90                                | 22.08                                | 73.24                                | 6.77      | AA40-40160-10-H-□ |
| 40 系列 80x80 8 槽      | 1535.25                | 110.89                                | 110.89                                | 27.72                                | 27.72                                | 4.15      | AA40-8080-8-□     |
| 40 系列 80x80 8 槽 重型   | 2103.58                | 149.26                                | 149.26                                | 37.32                                | 37.32                                | 5.68      | AA40-8080-8-H-□   |
| 40 系列 80x160 12 槽    | 3613.82                | 289.39                                | 980.80                                | 72.35                                | 122.60                               | 9.76      | AA40-80160-12-□   |
| 40 系列 120x120 12 槽   | 4073.42                | 662.90                                | 662.90                                | 110.48                               | 110.48                               | 11.00     | AA40-120120-12-□  |

⚠️ “□”代表长度及补充加工, 详见 P 11 - P 16。  
若整根订制, 直接使用订购编号即可。

推荐连接件 .....



压铸角铝 P34



挤压角铝 P44



槽内直线件 P58



内置连接件 P58



大螺栓 P59



端连接件 P59



L 形角槽连接件 P60